

December 1, 2003

Ms. Bertha Little
CCDA
Chaparral, NM 88081

Dear Ms. Little,

I would first like to thank you for the time you have given me to discuss the district's need to change the location of the proposed Chaparral High School. Last school year, the CCDA indicated that their first choice, from the five given, was the site located on the western end of Lisa Drive near the transmission towers. I am asking on behalf of the district that the second choice be accepted by the CCDA as the site for Chaparral High School. The second site is the one located on the northern end of Anthony Prescott Drive, west-southwest of the newly built Sunrise Elementary. The site will be either on privately donated land or on BLM property.

From our previous conversations, I understand that the concern with the second site was the closeness to the newly constructed Sunrise Elementary. The proposed high school campus and the elementary campus will be two separate campuses that will be fenced and accessed independently. It is my belief that the close proximity will lend itself to providing assistance programs between the two campuses whereby high school students could be utilized in joint educational programs. There are many examples across the country of high school programs supporting elementary campuses.

Our reasons for locating the high school at the Anthony Prescott Drive location are as follows:

- 1) In our presentation to the legislature, we focused on the issue of a high school as the focal point of the community and the transportation situation that currently exists in getting the students to Gadsden High School. In one of my conversations with the Capital Outlay people, it was mentioned that the west Lisa Drive location is basically outside of the main population center of the community and would require the same amount of busing, only 15 miles shorter.
- 2) The west Lisa Drive location would require that all transportation (either personal vehicles or buses) pass on Lisa Drive in front of the three existing schools creating more traffic in an area that is already overly congested.

- 3) Utility services are easier to access at the Anthony Prescott site in particular the setting up of a sewage system that could be jointly maintained for both the high school and Sunrise thus saving the district considerable expense on the overall project.
- 4) The Anthony Prescott Drive location is centrally located in terms of where the student population is in the community.

As you are well aware, funding for the Chaparral High School project is going to be heavily, if not totally supported by State resources. Anything that we can do as a district that will help to expedite and insure the funding of this project will be to everyone's advantage. I greatly appreciate you taking the time to share our needs with the CCDA and look forward to hearing from you in the very near future.

Sincerely,

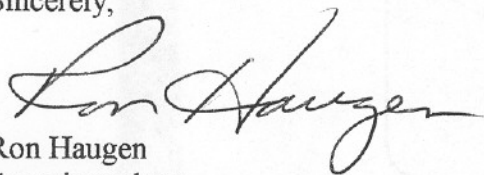
A handwritten signature in cursive script that reads "Ron Haugen". The signature is written in dark ink and is positioned above the printed name and title.

Ron Haugen
Superintendent

PROPOSED SITE FOR HIGH SCHOOL IN CHAPARRAL, NEW MEXICO

CCDA Choice

District Choice

BLM Proposed Site 1

BLM Proposed Site 2

BLM Proposed Site 3 +/- 80 ACRES

Proposed Site 4

Proposed Site 5 +/- 45 ACRES

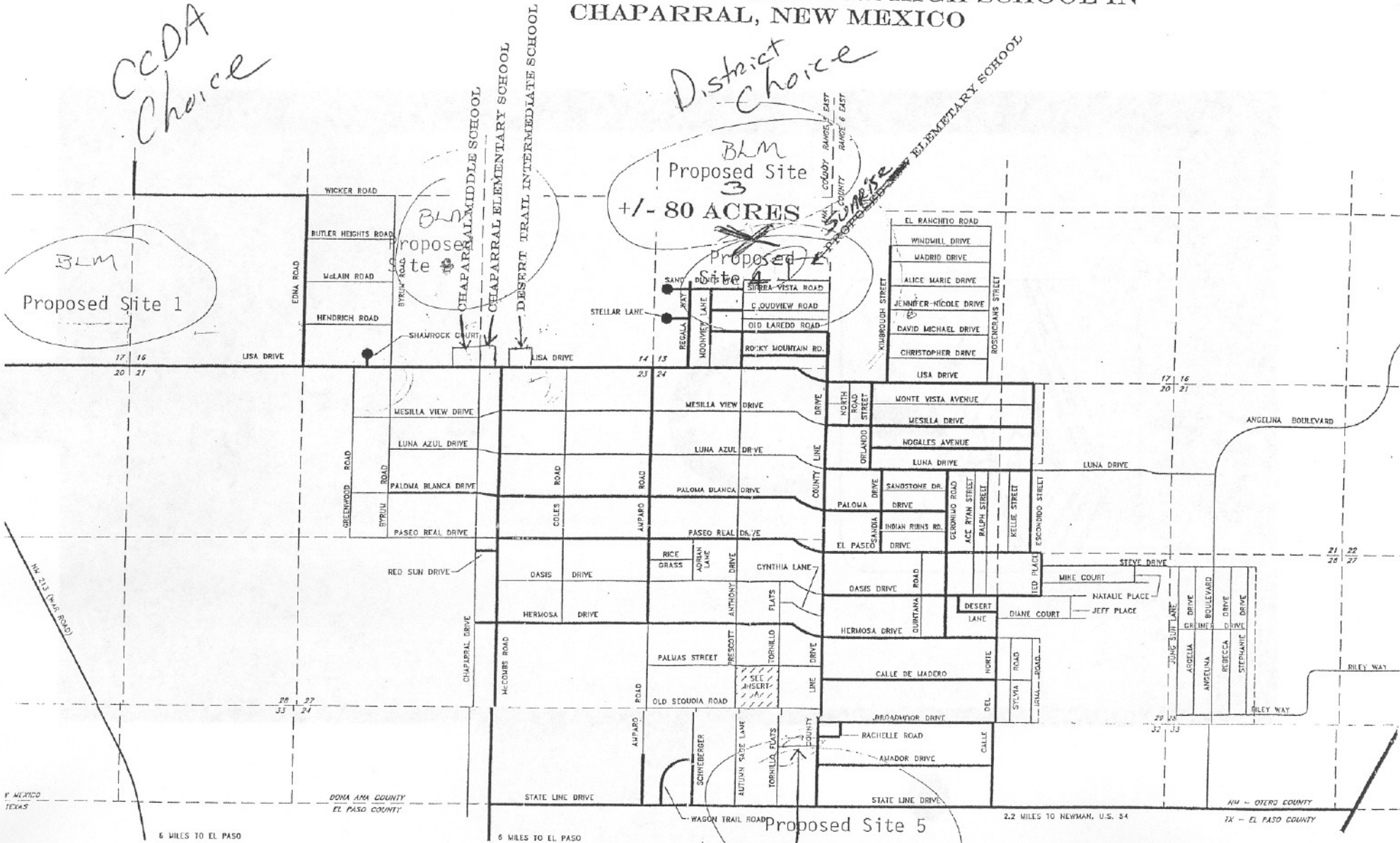

PROPOSED SITE FOR HIGH SCHOOL IN CHAPARRAL, NEW MEXICO

CCDA Choice

District Choice

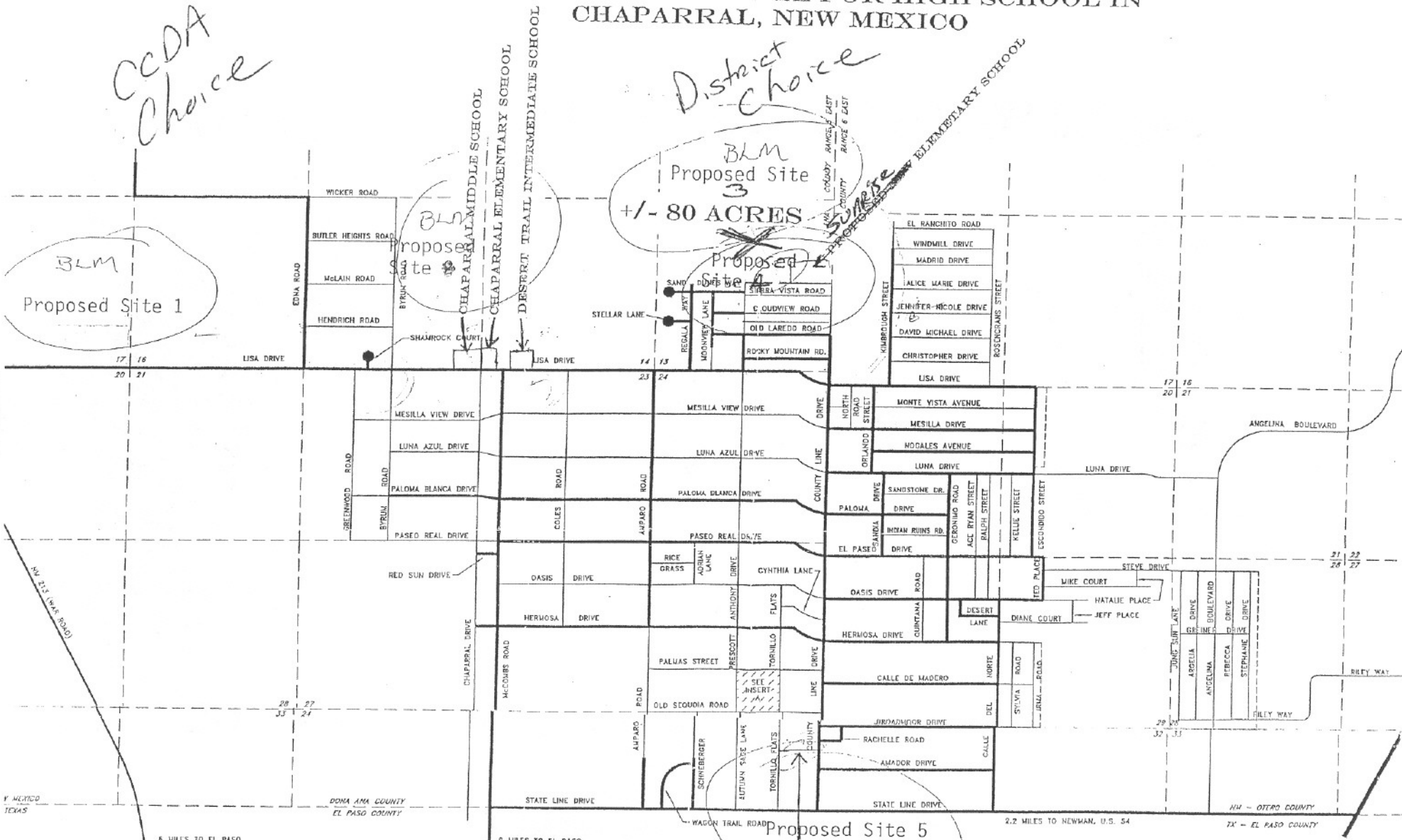

BLM Proposed Site 1

BLM Proposed Site +/- 80 ACRES

BLM Proposed Site +/- 45 ACRES

N. MEXICO TEXAS

DONA ANA COUNTY EL PASO COUNTY

6 MILES TO EL PASO

6 MILES TO EL PASO

2.2 MILES TO NEWMAN, U.S. 54

EL PASO COUNTY